

# Floor Plans & Dimensions

Health Professions Apartments I · 1308 E. Gaylord

Units 1-4-5-8-9-12

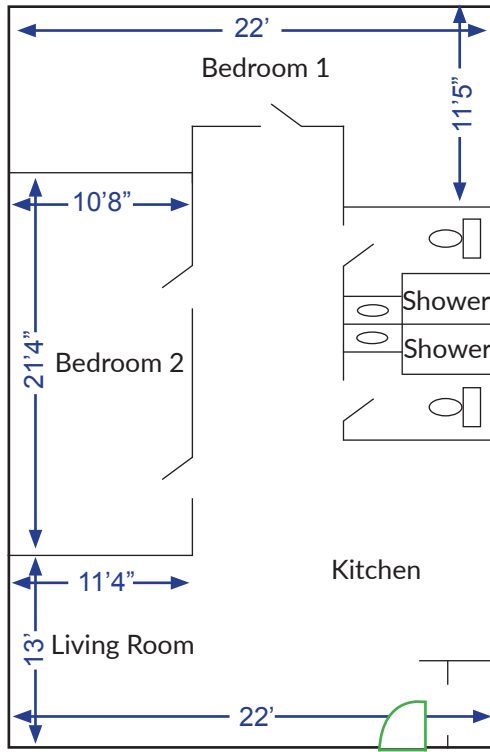

## North Building

All 2-bedroom units



7506



Loggia

7701



Cavern Clay

Units 2-3-6-7-10-11

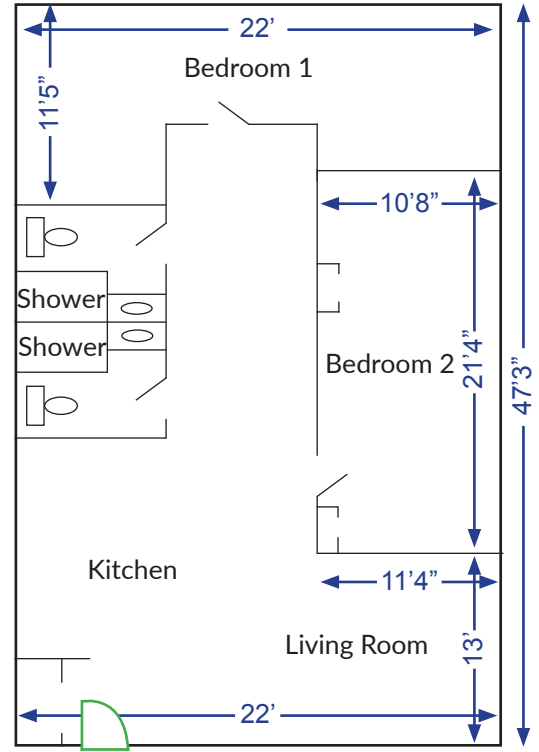

Units 14-16-18

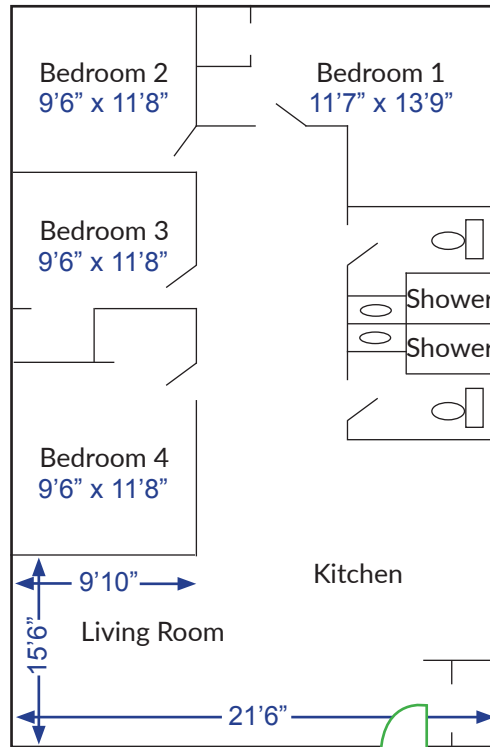

6004

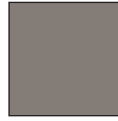

Mink

6222



Riverway

## South Building

All 4-bedroom units

Units 13-15-17

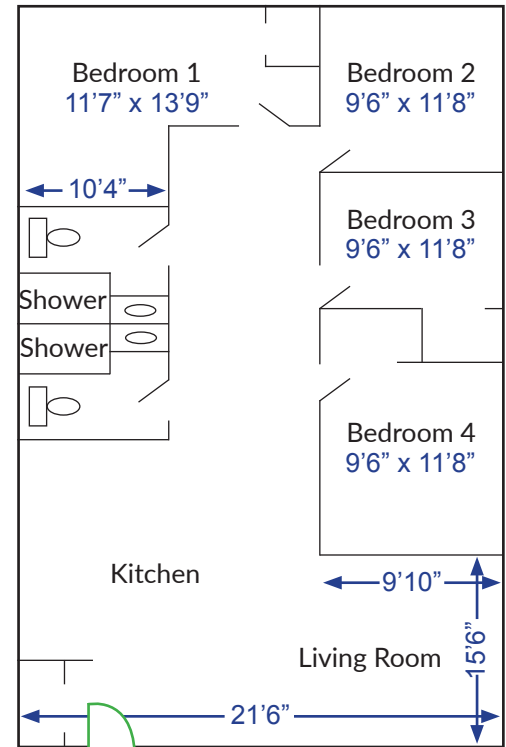

(248) 876.4770



healthapartments@gmail.com



28328 Golf Pointe Blvd | Farmington Hills, MI 48331



www.cmu4lease.com